

Borehole Passenger

Application Summary

This is the traditional design used for decades. It utilizes a single-stage hydraulic jack installed in the ground. The jack is located directly under the car, near the center of the platform.

- This design can accommodate both **passenger** and **freight** applications.

Advantages:

- Usually the lowest material cost application.
- Accommodates front and rear openings in any configuration.
- No extensive pit or overhead is required.
- Available for both low and high capacity cars.
- Of all the application types, this equipment package is the easiest to install.

Disadvantages:

- Oil contamination in the ground is possible. As a precaution, the jack can be enclosed in PVC pipe. Areas with frequent seismic activity will have the greatest risk of oil contamination.
- The jack must go down into the ground roughly the same distance as the desired travel. Drilling a jack hole is expensive and may be nearly impossible in certain structural or geologic conditions.

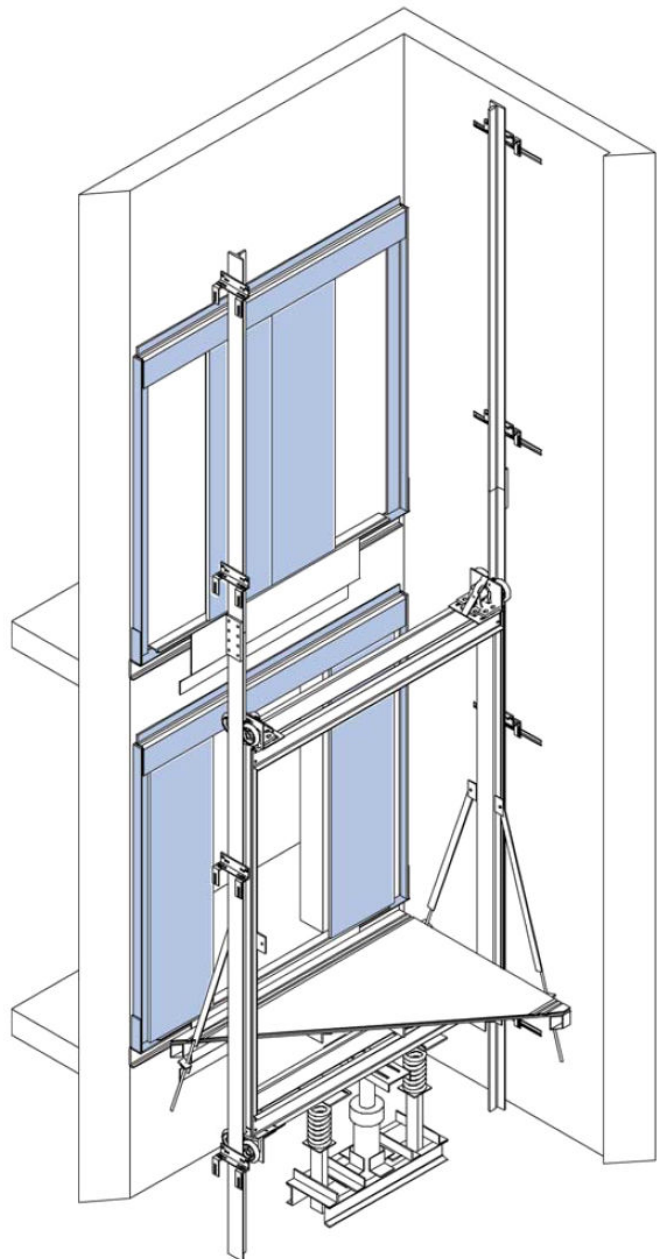

Borehole Passenger, Low Capacity

Cap.	Platform	Hoistway	Cab Height	Pit Depth	Minimum Overhead	Front (F) Rear (R)	Laminate Clear Inside	Door Type	Door Width
2100	6'-0" x 5'-1"	7'-4" x 5'-9"	8'-0"	4'-0"	12'-0"	F	5'-9" x 4'-3 1/2"	1-SP	3'-0"
2100	6'-0" x 5'-8"	7'-4" x 6'-8 1/2"	8'-0"	4'-0"	12'-0"	F/R	5'-9" x 4'-3 1/2"	1-SP	3'-0"
2500	7'-0" x 5'-1"	8'-4" x 5'-9"	8'-0"	4'-0"	12'-0"	F	6'-9" x 4'-3 1/2"	1-SP	3'-6"
2500	7'-0" x 5'-8"	8'-4" x 6'-8 1/2"	8'-0"	4'-0"	12'-0"	F/R	6'-9" x 4'-3 1/2"	1-SP	3'-6"
3000	7'-0" x 5'-6"	8'-4" x 6'-2"	8'-0"	4'-0"	12'-0"	F	6'-9" x 4'-8 1/2"	1-SP	3'-6"
3000	7'-0" x 6'-1"	8'-4" x 7'-1 1/2"	8'-0"	4'-0"	12'-0"	F/R	6'-9" x 4'-8 1/2"	1-SP	3'-6"
3500	7'-0" x 6'-2"	8'-4" x 6'-10"	8'-0"	4'-0"	12'-0"	F	6'-9" x 5'-4 1/2"	1-SP	3'-6"
3500	7'-0" x 6'-9"	8'-4" x 7'-9 1/2"	8'-0"	4'-0"	12'-0"	F/R	6'-9" x 5'-4 1/2"	1-SP	3'-6"
3500 H	5'-4" x 8'-4"	6'-8" x 9'-2"	8'-0"	4'-0"	12'-0"	F	5'-1" x 7'-5"	2-SP	3'-6"
3500 H	5'-4" x 9'-0 1/2"	6'-8" x 10'-4"	8'-0"	4'-0"	12'-0"	F/R	5'-1" x 7'-5"	2-SP	3'-6"
4000	8'-0" x 6'-2"	9'-4" x 7'-0"	8'-0"	4'-0"	12'-0"	F	7'-9" x 5'-3"	2-SP	4'-0"
4000	8'-0" x 6'-8"	9'-4" x 7'-11 1/2"	8'-0"	4'-0"	12'-0"	F/R	7'-9" x 5'-0 1/2"	2-SP	4'-0"
4000 H	6'-0" x 8'-5"	7'-4" x 9'-3"	8'-0"	4'-0"	12'-0"	F	5'-9" x 7'-6"	2-SP	4'-0"
4000 H	6'-0" x 9'-1 1/2"	7'-4" x 10'-5"	8'-0"	4'-0"	12'-0"	F/R	5'-9" x 7'-6"	2-SP	4'-0"
4500 H	6'-0" x 9'-2"	7'-4" x 10'-0"	8'-0"	4'-0"	12'-0"	F	5'-9" x 8'-3"	2-SP	4'-0"
4500 H	6'-0" x 9'-10 1/2"	7'-4" x 11'-2"	8'-0"	4'-0"	12'-0"	F/R	5'-9" x 8'-3"	2-SP	4'-0"
5000 H	6'-0" x 9'-7 1/2"	7'-6" x 10'-5 1/2"	8'-0"	4'-0"	12'-0"	F	5'-9" x 8'-8"	2-SP	4'-0"
5000 H	6'-0" x 10'-3 1/2"	7'-6" x 11'-7"	8'-0"	4'-0"	12'-0"	F/R	5'-9" x 8'-8"	2-SP	4'-0"

Borehole Passenger, High Capacity

6000	7'-0" x 8'-6"	8'-6" x 9'-4"	8'-0"	4'-0"	12'-0"	F	6'-9" x 7'-7"	2-SP	4'-0"
6000	7'-0" x 9'-2 1/2"	8'-6" x 10'-6"	8'-0"	4'-0"	12'-0"	F/R	6'-9" x 7'-7"	2-SP	4'-0"
8000	8'-4" x 10'-0"	9'-10" x 10'-10"	8'-0"	4'-0"	12'-0"	F	8'-1" x 9'-1"	2-SP	4'-0"
8000	8'-4" x 10'-8 1/2"	9'-10" x 12'-0"	8'-0"	4'-0"	12'-0"	F/R	8'-1" x 9'-1"	2-SP	4'-0"
10000	8'-4" x 11'-8 1/2"	9'-10" x 12'-6 1/2"	8'-0"	4'-0"	12'-0"	F	8'-1" x 10'-9 1/2"	2-SP	4'-0"
10000	8'-4" x 12'-5"	9'-10" x 13'-8 1/2"	8'-0"	4'-0"	12'-0"	F/R	8'-1" x 10'-9 1/2"	2-SP	4'-0"
12000	10'-4" x 11'-6"	11'-10" x 12'-4"	8'-0"	4'-0"	12'-0"	F	10'-1" x 10'-7"	2-SP	4'-0"
12000	10'-4" x 12'-2 1/2"	11'-10" x 13'-6"	8'-0"	4'-0"	12'-0"	F/R	10'-1" x 10'-7"	2-SP	4'-0"
15000	12'-0" x 11'-5"	13'-6" x 12'-3"	8'-0"	4'-0"	12'-0"	F	11'-9" x 10'-6"	2-SP	4'-0"
15000	12'-0" x 12'-1 1/2"	13'-6" x 13'-5"	8'-0"	4'-0"	12'-0"	F/R	11'-9" x 10'-6"	2-SP	4'-0"

H = Hospital Elevator



Lift Solutions, Inc

tel: 360/862-8328

fax: 425/671-0758

www.liftsolutions.net

info@liftsolutions.net